

## Solenoid valve

### Model SV02



Solenoid valve SV02 can supply working medium to pipelines and cavities of a unit/system under commands of control system.

Status TRL – 6

Type: Normally closed, 2-way, direct action

### Main technical characteristics

Working medium	Non-cryogenic gases and liquids
Max working pressure, bar	100
Burst pressure, bar, no less	250
Operation temperature range, °C	from minus 30 to plus 60
Voltage*, Vdc	from 24 to 32
Max power consumption (@ 20 °C), W	32.5
Passage diameter, mm	1.5
Max response time, s	0.02
Internal leakage, sm <sup>3</sup> /s air, no more	0.5
External leakage, m <sup>3</sup> ·Pa/s GHe	1.33·10 <sup>-7</sup>
Flow capacity Kv, m <sup>3</sup> /h, no less	0.063
Mass, kg, no more than	0.13
Overall dimensions**, mm	see.fig.1

\* - for long-term activation (more than 180 s), it is recommended to reduce the voltage after activation by 1...3 s.

\*\* - the overall dimensions and interfaces of the ports may vary depending on the customer's requirements.

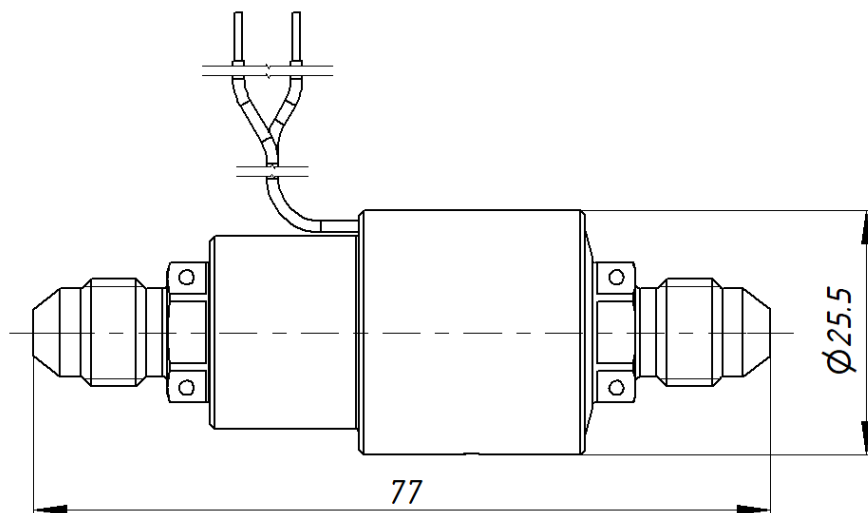

Figure 1 – Overall dimensions\*\*